



New room design for the Swan (758 guest rooms)

Renovations complete, ready to enjoy

Guestrooms

Rate \$159; Additional person \$25 – lower cost than economy hotel, plus no taxi fees needed

Special rates offered 3 days prior & 3 days after the meeting dates – for a wonderful family vacation

Lower-priced evening tickets to Disney parks available for conference attendees

Disney property guests eligible for extended park hours and free shuttle service to the parks

Hotel Resort Fee \$0 – waived for ICTAC - Includes unlimited local calls and 800 calls up to 60 min., long distance access, complimentary bottled water daily, high speed internet access, and unlimited admission to fitness centers

Global Collaboration

ICTAC Executive Committee 2015

President: Wim de Klerk, The Netherlands

Secretary: Prof. Ranjit Verma, India

Treasurer: Dr. Pierre le Parlouer, France

Membership Secretary: Dr. Junko Morikawa, Japan

Web: www.ictac.org

NATAS Executive Council 2016

President: Chris Li, Drexel University

Vice-President: Queenie Kwok, NRCan Canadian Explosives Research Laboratory

Secretary: Holly Salerno, Dupont Experimental Station

Treasurer: Steve Sauerbrunn, University of Delaware

Executive Councilor: Peggy Cebe, Tufts University

Web: www.natasinfo.org



Please join us at the Swan and Dolphin in Orlando, Florida

August 14th – August 19th, 2016

ICTAC 2016

*International Confederation
for Thermal Analysis and
Calorimetry*



ICTAC 2016

Hosted by the North American
Thermal Analysis Society

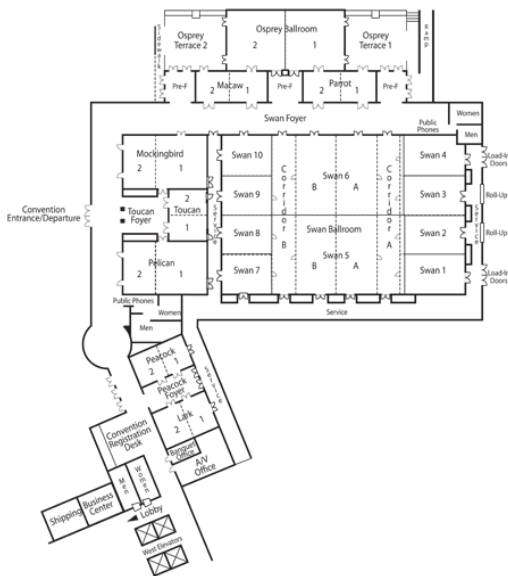

Meeting Spaces are Spacious and Flexible

General schedule:

- Poster session and welcome mixer Sunday evening
- Presentations 8AM to 5PM daily, concluding with lunch on Friday
- Three concurrent sessions
- **Special activity with entertainment being planned for Wednesday afternoon and evening**
- **Awards Banquet Thursday evening**
- Plenary session at start of each half day
- 40-minute featured paper at start of each session (as selected by session co-chairs)
- 20-minute contributed papers (including question period)

Conference Organizers:

Chair: Tina Adams **Co-chair:** Prof. Bob Howell

Program Co-chairs: Eric Schoch (Americas), Riko Ozao (Asia), & Crisan Popescu (Europe)

Proposed Technical Sessions:

Kinetics and Catalysis

Lifetime Prediction

Pharmaceuticals

Personal Care

Biomaterials, Biopolymers

Energetic Materials and Thermal Hazards

Instrumentation and Methods

Fuels and Biofuels

Inorganic Materials, Geochemistry, and Ceramics

Fast Scanning Methods

High Temperature Thermal Analysis

Composites, Nano-composites

Glass, Thermosets, & Nanoconfinement

Materials Processing

Plastic Packaging

Process Safety

Polymer Stability, Degradation, Flammability

Polymer Phase Transformation

Rheology and Viscoelasticity

Thermal Analysis in Forensics - *new*

Thermal Transport and Electrical Properties

Thin Films and Nano-confinement

Sustainability, Bio-sourced Materials, Green Chemistry

Molecular Biophysics/Biochemistry

Pyrolytic Methods

Food Technology

Wood Technology

Life Sciences - *new*



In the heart of Walt Disney World Resort, about 20 minutes from Orlando International Airport

Walt Disney World Swan and Dolphin

1500 Epcot Resorts Boulevard

P.O. Box 22653

Lake Buena Vista, FL 32830

USA www.swandolphin.com

Make your reservations now: Link on the NATAS website under Conferences - ICTAC 2016

To/From Airport:

Mears shuttle every hour (on the ½ hour): Round trip pricing with coupon \$37 (adult), \$28 (age 4-11), free (under age 3) ... **coupon and portal links now available on the NATAS website www.natasinfo.org** (Taxi: approx. \$60.00)

Abstract Submission portal open now – deadline May 6th

Registration portal open now

... full conference fee \$875, students \$300 for members, early registration